



Keyboard & Mouse Converter

For PS4/PS3/Switch/Oled/Xbox Series X/
Xbox Series S/ XBox one/XBox 360

User Manual

HC-A35A8



This Keyboard & Mouse Converter, supports PS4, PS3, Switch,Oled, Xbox One,Xbox One Series S/X, XBox 360 game platforms, to convert the original wired controller function to Keyboard and Mouse.(Keyboard & Mouse Converter, hereafter referred to as converter)

【Function indication】



【Function Introduction】

- USB Output: DC 5V, 500MA (Max output).
- Type-C Input: For connecting with game console, the indicator light on the keyboard & mouse converter turns white.
- 3.5 audio jack: An audio signal output port.
- Game Controller Port: After plugging in the game controller, the indicator light on the converter turns yellow.
- Keyboard/Mouse Port 1: A keyboard or mouse can be plugged in, and the indicator light of the converter turns red after plugging in.
- Keyboard/Mouse Port 2: A keyboard or mouse can be plugged in, and the indicator light of the converter turns green after plugging in.

【Function setting】

- ① Connect the converter with game console by Type-C data cable, the indicator light of converter turns white 1 Second. ○
- ② Connect game controller to the converter, the indicator light turns yellow 1 Second. ●
- ③ The indicator light turns red 1 Second when keyboard or mouse plug in Port 1. ●
- ④ The indicator light turns green 1 Second when keyboard or mouse plug in Port 2. After completed all the connections, the indicator light turns yellow, blue, purple and pink cyclic breathing light. ●
- ⑤ Start setting, press Key_F11, Key_F12 on the keyboard at the same time → the indicator light of converter turns to the blue, breathing light to stay on.
- ⑥ Press any one of the left/right/up/down buttons of the controller first without letting go, press the left or right button of mouse at the same time, or press any button on the keyboard, the functions on the Controller have been copied to the keyboard or mouse (special attention: When setting, press and hold the buttons on the controller and the buttons of the mouse or keyboard at the same time, otherwise it cannot be copied)
- ⑦ When the copy is complete, press Key_F12 and Key_F11 on the keyboard at the same time, indicator light on the converter will turn white (the setting is over). The setting button on the keyboard and mouse the same to Controller.
- ⑧ Press Key_F9+Key_F10+Key_F12 at the same time for more than 3 seconds to clear the setting function → the keyboard and mouse LED turns blue and then yellow, (restore the initial default function).



Warn: You can set other function of controller as above, or customize function setting on other game console.

【Notes】

1. When the wired controller is plugged into the converter, the indicator light does not turn yellow or cannot be used.

① Check whether the port is well connected, and confirm the controller is connection

② After the SWITCH Console is connected to the converter, the keyboard and mouse converter is plugged into the wired switch pro controller with data cable, and the keyboard and mouse converter cannot use the setting copy function; Click on the main interface to enter "Settings" (Figure 1 shows), scroll down to find "Controller and Sensors"(Figure 2 shows), click to find " Pro wired controller connection method"(Figure 3 shows), change it to "on" state. In "Change the grip/order of the Controller"(Figure 4 shows), change it to the wired connection mode.

③ On PS4 console, enter the main interface and click settings, find the Devices and click in, then click controllers, select the Communication Method for USB Cale; The indicator light turns yellow, and the converter can be set normally.

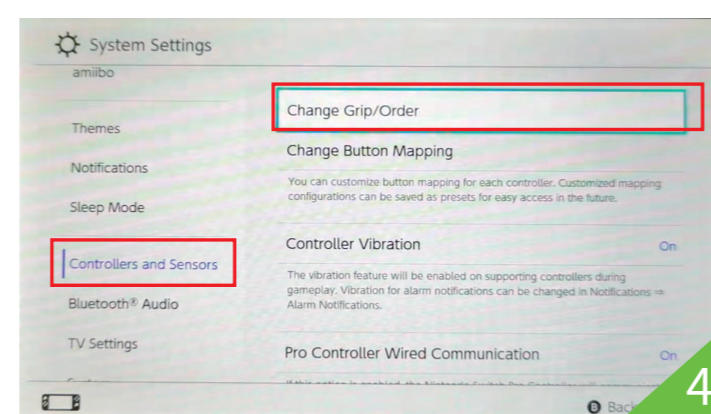
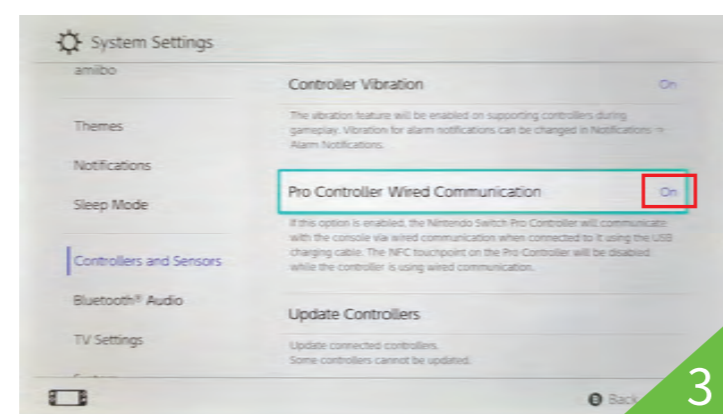
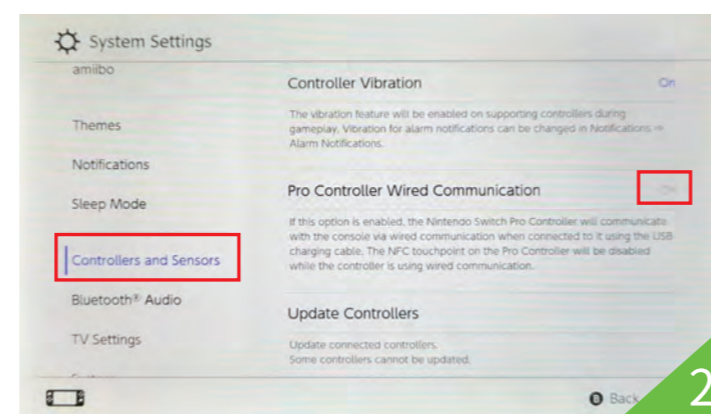
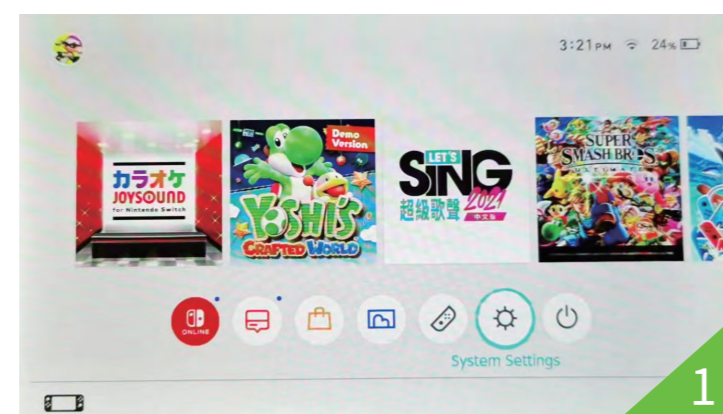

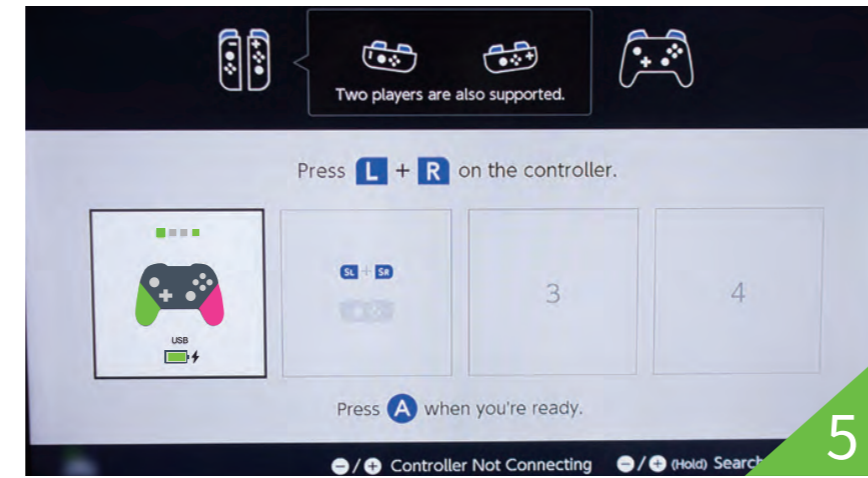

2. When SWITCH console is connected to the keyboard/mouse via converter, the keyboard/mouse can only use the default function if the pro controller is wireless, not the setting function; if you need to set the function by yourself, you must plug in the data cable to the controller to use it.
3. If the original controller is wireless connected to the PS4 console first, after that use the converter to connect the PS4 console with the controller(with data cable), keyboard and mouse; This time the keyboard/mouse cannot use the default functions and setting functions, and you need to press the PS button to restart the controller to use it.
4. When the keyboard or mouse is plugged into the ports 1 and 2, the indicator light does not turn on. Check whether the port is properly connected and whether the keyboard or mouse is damaged and cannot be used.
5. If you do not press the controller function key during the setting process, the original set function on the keyboard or mouse will be cleared; push to the end in the 3D direction (only supports up, down, left, and right settings); D-pad can support 8 direction settings.
6. XBox 360 and PS3 game platforms do not support 3.5 audio output.
7. Xbox360 does not support wireless controller.
8. If press KEY_F12 + KEY_F10 + KEY_F9 (long press for 3 seconds) cannot return to the default function on some keyboards, please press KEY_F12 + KEY_F10 + KEY_F1-KEY_F2 (long press for 3 seconds) to return to the default function.
9. The maximum output of the 5V power is 500mAh.

【Mouse sensitivity selection】

This function is to adjust the moving speed of the mouse, which can be selected according to the game operation requirement. The default value is 4.

Press KEY_F12 and the number keys 1-9 above the English letters at the same time. 1 is the lowest sensitivity and 9 is the highest.

【Mouse Y-axis direction switch】

- In some games, the direction of the Y-axis is set to the opposite direction. Users can choose according to the game and using habit.
- Press F12 and Y at the same time to switch the Y-axis direction of the mouse.

【Function switching】

1. Set mode Key_F12 + Key_F11.
2. Select Key_ F12 + Key_F1-F8 in the preset.
3. Mouse sensitivity selection, Key_F12 + 1-9.
4. Switch the direction of mouse Y axis F12 + Y.
5. Return to the default F12 + F10 + F9 (long press for 3 seconds).

【Default function】

Mouse Button	Page 1(F1)				
	Switch/Oled	PS3/PS4	Xbox Series S/X	XBOX ONE	XBOX 360
Right Button	L2	L2	L2	L2	L2
Left Button	R2	R2	R2	R2	R2
Up	Right Stick Up	Right Stick Up	Right Stick Up	Right Stick Up	Right Stick Up
Left	Right Stick to Left	Right Stick to Left	Right Stick to Left	Right Stick to Left	Right Stick to Left
Right	Right Stick to Right	Right Stick to Right	Right Stick to Right	Right Stick to Right	Right Stick to Right
Down	Right Stick Down	Right Stick Down	Right Stick Down	Right Stick Down	Right Stick Down
Slide upper left 45 degrees	Right Stick Upper Left	Right Stick Upper Left	Right Stick Upper Left	Right Stick Upper Left	Right Stick Upper Left
Slide the upper right 45 degrees	Right Stick Upper Right	Right Stick Upper Right	Right Stick Upper Right	Right Stick Upper Right	Right Stick Upper Right
Slide the bottom left 45 degrees	Right Stick Bottom Left	Right Stick Bottom Left	Right Stick Bottom Left	Right Stick Bottom Left	Right Stick Bottom Left
Slide the bottom right 45 degrees	Right Stick Bottom Right	Right Stick Bottom Right	Right Stick Bottom Right	Right Stick Bottom Right	Right Stick Bottom Right
Mouse Wheel	R3	R3	R3	R3	R3

Keyboard Buttons	Page 1(F1)					
	Switch/Oled	PS4	PS3	XBOX ONE	XBOX 360	Xbox Series S/X
W	Left Stick Up	Left Stick Up	Left Stick Up	Left Stick Up	Left Stick Up	Left Stick Up
A	Left Stick to Left	Left Stick to Left	Left Stick to Left	Left Stick to Left	Left Stick to Left	Left Stick to Left
S	Left Stick Down	Left Stick Down	Left Stick Down	Left Stick Down	Left Stick Down	Left Stick Down
D	Left Stick to Right	Left Stick to Right	Left Stick to Right	Left Stick to Right	Left Stick to Right	Left Stick to Right
WA	Left Stick Upper Left	Left Stick Upper Left	Left Stick Upper Left	Left Stick Upper Left	Left Stick Upper Left	Left Stick Upper Left
WD	Left Stick Upper Right	Left Stick Upper Right	Left Stick Upper Right	Left Stick Upper Right	Left Stick Upper Right	Left Stick Upper Right
SA	Left Stick Bottom Left	Left Stick Bottom Left	Left Stick Bottom Left	Left Stick Bottom Left	Left Stick Bottom Left	Left Stick Bottom Left
SD	Left Stick Bottom Right	Left Stick Bottom Right	Left Stick Bottom Right	Left Stick Bottom Right	Left Stick Bottom Right	Left Stick Bottom Right
SHIFT	L3	L3	L3	L3	L3	L3
~	Camera Button	SHARE	/	/	/	↕
Q	L1	L1	L1	L1	L1	L1
E	R1	R1	R1	R1	R1	R1
R	Y	△	△	Y	Y	Y
SPACE	A	×	×	A	A	A
F	X	□	□	X	X	X
C	B	●	●	B	B	B
ESC	HOME	PS	PS	HOME	HOME	HOME
TAB	BACK	Option	SELECT	View	BACK	View
UCAPSLOCK	START	Touchpad Buttons	START	MENu	START	MENu

