

# DKF810FK WIRELESS KEYPAD

This product can be used to form an alarm package with alarm panel. It can be operated with 16 buttons to switch the status of the security system to the platform, and users can access the status of the devices through the App, add and manage the devices, and set the functions.

## Packing List

After unpacking the product, please make sure that the device is intact, and check the following list to make sure that the accessories are complete.

- Keypad (×1)
- Expansion tube (×3)
- User manual (×1)
- AA size battery (×4)
- Bracket (×1)
- Screws (×3)

## Product Diagram

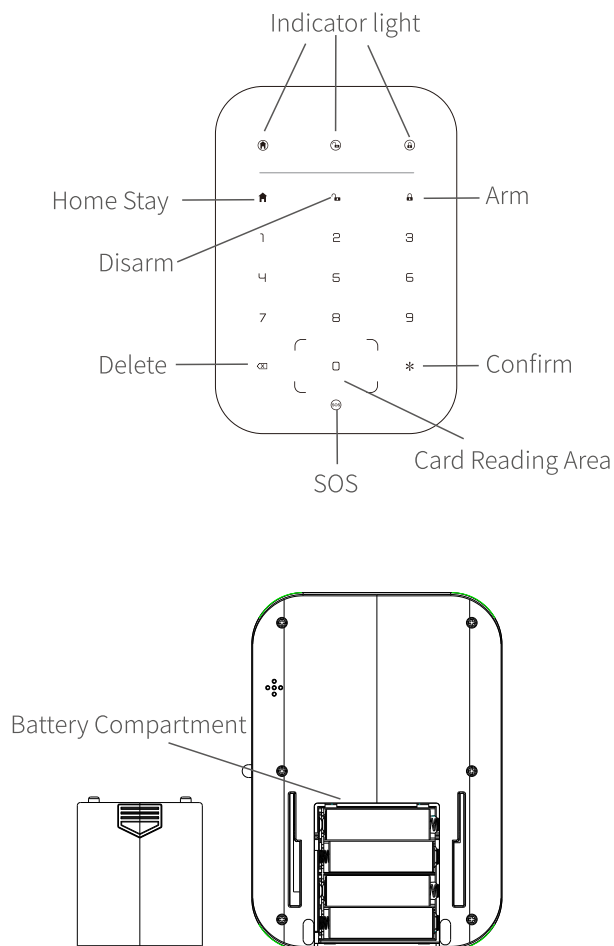

## Specification

Wireless Protocol	FSK
Transmit Frequency	868/433MHz
Transmit power	≤13dBm
Working Voltage	DC3V
Static Current	<100μA
Wireless Distance	800m (Open Area)
Working Temperature	-10°C~+55°C
Working Humidity	≤95%RH
Product Size	117×167×23mm

## Usage

### 1. Secusystem App

Scan the following QR codes with your smart phone to download "Secusystem" App, or search and download from Google Play Store and App Store.



iOS APP



Android APP

### 2. Adding Devices

- (1) Open the App. Follow the Alarm Panel User Manual to add the alarm panel to the App.
- (2) After the panel is successfully bound, select APP "+" > "Add sub-device" > "Scan the device's QR code" and follow the instructions for subsequent operations, as shown in the screenshots.

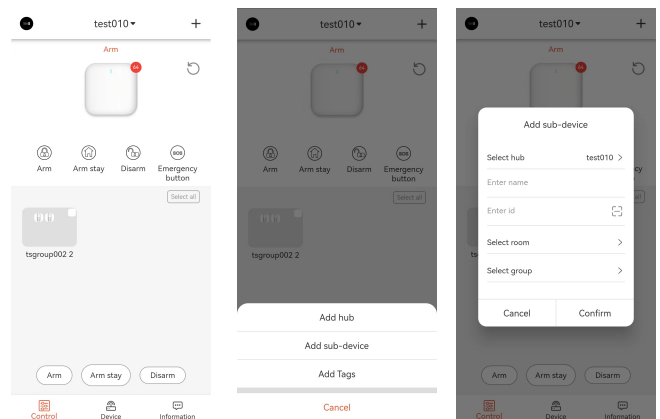

- (3) Long press the “delete” and “confirm” button for 3 seconds, the green light will flash and the device enters network configuration mode.
- (4) Wait for the alarm panel to be added successfully. Once added, the panel will send out a "ding dong" sound, if it fails, please try the above steps again.
- (5) Common button operation: After the screen lights up, the button buzzer will sound.
- (6) SOS button operation: the screen lights up, long press the SOS button for more than 3 seconds, the buzzer sounds.
- (7) Press the key to arm and disarm, and read the card to arm and disarm.
- (8) When the battery voltage is low, a warning message will be displayed on the APP.

## 16 keys:

- 0-9 are number keys
- 1 function key and 1 delete key.
- 3 arm and disarm keys: Arm, Arm Stay and Disarm.
- 1 emergency button.

## 3. Function description

- (1) This product is used with the alarm panel. If the keypad is used for the first time or replaced, it needs to be connected with the alarm panel first.
- (2) Please follow the steps of adding sub-device to add this product to the alarm panel.
- (3) This product has a low voltage reminder function. When the battery voltage is low, the device sends a low voltage alert to the alarm panel.
- (4) This product has a sensitivity adjustment function, which can be configured through the APP.
- (5) This product has a heartbeat configuration function, which can be configured through APP 36~128S.
- (6) This product has an anti-tamper switch, and the red light will flash once when the device is tampered and send a tamper alarm message to the alarm panel.

## 4. Add RFID Card

- (1) Click “+” in the APP;
- (2) Choose alarm panel and keypad password;
- (3) Put the RFID card close to the sensing area until hearing the "beep" sound..

## Installation

1. To install the product with the support bracket, select the wall mounting location, secure the support base to the wall with screws, and put on the screw cap.

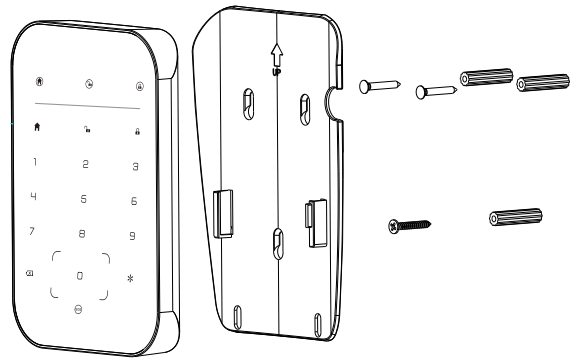

2. Insert the main body downward into the support bracket to complete the installation.

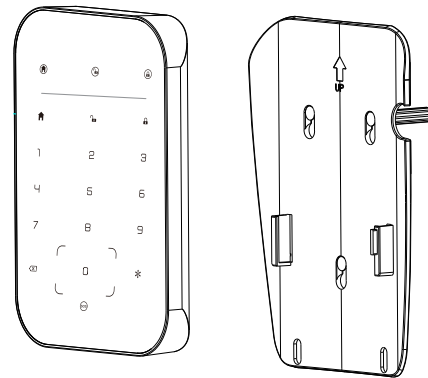

## Warranty

Dear user, thank you for choosing our products, please read the following carefully before installing and using this product:

1. The warranty period of this product is within 1 year from the date of purchase, and our company will provide free repairs for any faults caused by the quality problems of the product itself under normal use. If you have any quality problems with the product within seven days from the date of purchase, you can enjoy free exchange.

2. The following conditions are not covered by the warranty:

- Malfunctions or defects caused by improper use environment or conditions;
- Other faults or damages not caused by the design, technology, production, quality and other problems of the product itself;
- Faults or defects caused by the use of third-party products, software or components;
- Malfunctions or defects caused by improper installation, misuse, unauthorized repair, modification, accident, force majeure or other external causes;
- The product is out of warranty.